

Datasheet MTN 25/150 N

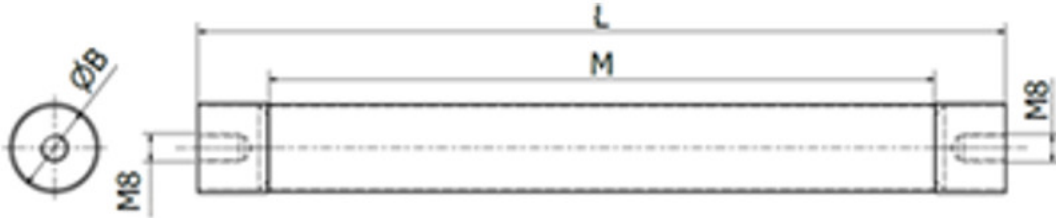

| Model | M (mm) | Weight (kg) | Standard surface flux density | Standard surface treatment | Standard temperature limit |
|--------------|--------|-------------|-------------------------------|----------------------------|----------------------------|
| MTN 25/100 N | 50 | 0,3 | 12 000 G (1,2 T) | Polishing | Approx. 60 °C |
| MTN 25/150 N | 100 | 0,5 | | | |
| MTN 25/200 N | 150 | 0,6 | | | |
| MTN 25/250 N | 200 | 0,9 | | | |
| MTN 25/300 N | 250 | 1,1 | | | |
| MTN 25/350 N | 300 | 1,4 | | | |
| MTN 25/400 N | 350 | 1,7 | | | |
| MTN 25/450 N | 400 | 2 | | | |
| MTN 25/500 N | 450 | 2,2 | | | |

| Parameter name | Value |
|---|--|
| Description: | Magnetic rod |
| Separator placement: | feeding hopper, inside of a pipeline, across the conveyor belt |
| Material flow direction (beginning with the most common one): | vertical, horizontal |
| Max. magnetic induction (depending on the type of the separator it is either a magnetic value on the surface of the separator or a magnetic value that is in direct contact with the treated material. Tolerance +/- 10 %): | 12000 |
| Weight of the separator (kg): | 0.5 |
| Application (= the material that the application of this separator is suitable for): | bulk material |
| Separator is suitable also even for the materials of poor bulk properties: | no |

| | |
|--|--|
| Minimum size of the particles that can be captured by the separator (mm): | 0.03 |
| Separator is able to capture paramagnetic particles: | yes |
| Separator is suitable for abrasive materials (1 = strongly abrasive, 2 = slightly abrasive, 3 = non-abrasive): | 3 |
| Separator is suitable for materials that tend to solidify (the materials must be heated): | no |
| Separation of non-ferrous metals: | no |
| Cleaning of the separator: | manual cleaning (without easy cleaning system), a need of interrupting the material flow |
| Max. operating temperature/ max. temperature of the material (°C): | 60 |
| Min. surrounding ambient temperature (°C): | -25 |
| Max. surrounding ambient temperature (°C): | 45 |
| Built-in standard magnet type | neodymium magnet N52 |
| Diameter of the outer (protective) tube of the magnetic rod (mm): | 25 |
| System tube in tube (it concerns grate type separators only): | ne |
| Material of the separator body (that is in contact with the treated material): | DIN 1.4301 |
| ATEX specification (number): | 20, 21, 22 |
| Outer surface treatment of the separator: | polished |
| Magnetic system: | magnetic tube |
| Connection possibilities of the separator (the variant mentioned as the first is the standard one): | M8 tapped hole |
| Max. operation time (hours/day): | 24 |
| Max. production time for a standard version (if not available in stock) (weeks): | 8 |
| Standard packing: | stretch wrap + cardboard box |
| Other packing modes (surcharged options): | wooden case, palúlet, maritime packing according to clients needs |
| Warranty (months): | 12 |