

Datasheet MTN-T 25/300 N

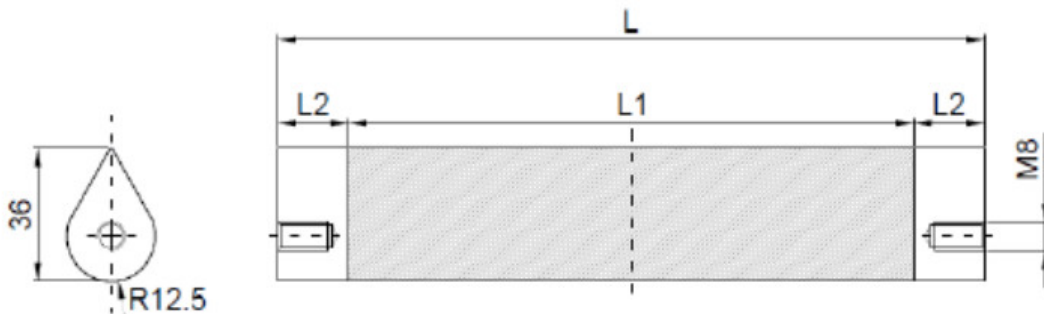

Model	M (mm)	Weight (kg)	Standard surface flux density	Standard surface treatment	Standard temperature limit
MTN-T 25/150 N	110	0,75	12 000 G (1,2 T)	Polishing	Approx. 80 °C
MTN-T 25/200 N	160	1,0			
MTN-T 25/250 N	210	1,25			
MTN-T 25/300 N	260	1,5			
MTN-T 25/350 N	310	1,75			
MTN-T 25/400 N	360	2,0			
MTN-T 25/450 N	410	2,25			
MTN-T 25/500 N	460	2,50			

Parameter name	Value
Description:	Teardrop magnet
Separator placement:	feeding hopper, inside of a pipeline, across the conveyor belt
Material flow direction (beginning with the most common one):	vertical, horizontal
Max. magnetic induction (depending on the type of the separator it is either a magnetic value on the surface of the separator or a magnetic value that is in direct contact with the treated material. Tolerance +/- 10 %):	12000
Weight of the separator (kg):	1.5
Application (= the material that the application of this separator is suitable for):	bulk material

Separator is suitable also even for the materials of poor bulk properties:	no
Minimum size of the particles that can be captured by the separator (mm):	0.03
Separator is able to capture paramagnetic particles:	yes
Separator is suitable for abrasive materials (1 = strongly abrasive, 2 = slightly abrasive, 3 = non-abrasive):	3
Separator is suitable for materials that tend to solidify (the materials must be heated):	no
Separation of non-ferrous metals:	no
Cleaning of the separator:	manual cleaning (without easy cleaning system), a need of interrupting the material flow
Max. operating temperature/ max. temperature of the material (°C):	60
Min. surrounding ambient temperature (°C):	-25
Max. surrounding ambient temperature (°C):	45
Built-in standard magnet type	neodymium magnet N52
Diameter of the outer (protective) tube of the magnetic rod (mm):	25
System tube in tube (it concerns grate type separators only):	ne
Material of the separator body (that is in contact with the treated material):	DIN 1.4301
ATEX specification (number):	20, 21, 22
Outer surface treatment of the separator:	polished
Magnetic system:	magnetic tube
Connection possibilities of the separator (the variant mentioned as the first is the standard one):	M8 tapped hole
Max. operation time (hours/day):	24
Max. production time for a standard version (if not available in stock) (weeks):	8
Standard packing:	stretch wrap + cardboard box
Other packing modes (surcharged options):	wooden box, pallet, maritime packing according to clients needs
Warranty (months):	12

Standard threaded hole: M8, 15 mm deep, at both ends of the magnetic rod